

294.3m

CEM MERT

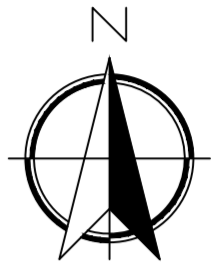

Poultry Houses to be Demolished
Shown Hatched

- Building 1 = 620m³
- Building 2 = 620m³
- Building 3 = 640m³
- Building 4 = 600m³
- Building 5 = 480 m³
- Building 6 = 480 m³
- Building 7 = 450 m³
- Total = 3890 sq m

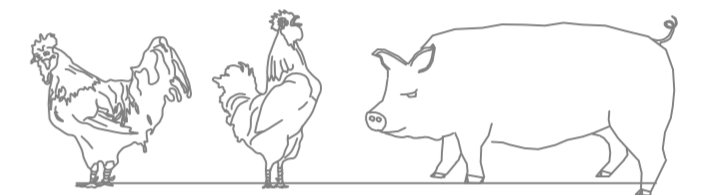

IAN PICK ASSOCIATES LTD
Specialist Agricultural & Rural Planning Consultants

Station Farm Offices
Wansford Road
Nafferton
Driffield
East Yorkshire
YO25 8NJ

T : 01377 253363
E : mail@ianpick.co.uk
W : www.ianpickassociates.co.uk

CLIENT
Aviagen Turkeys Ltd

JOB TITLE

Poultry Unit Redevelopment at
Byrn Golau, Saron, LL16 4TH

DWG. TITLE
Existing Site Plan A1

SCALE 1=500	DRN IP
----------------	-----------

DWG. NUMBER
IP/ATL/02

DATE Feb 23	REV -
----------------	----------

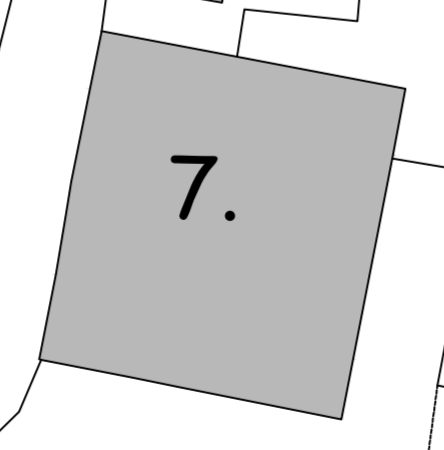
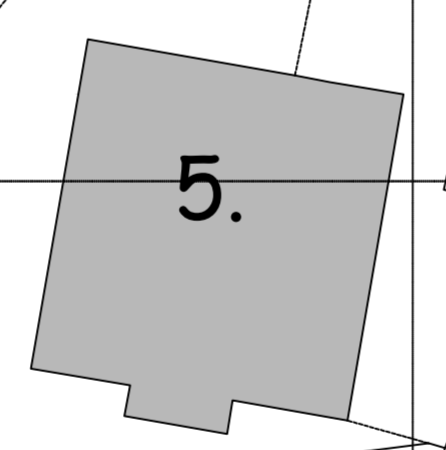
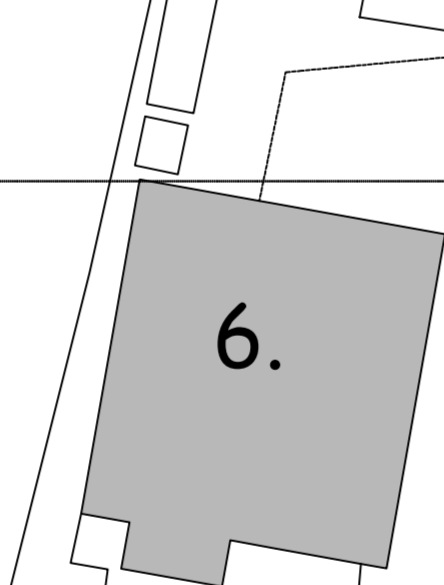
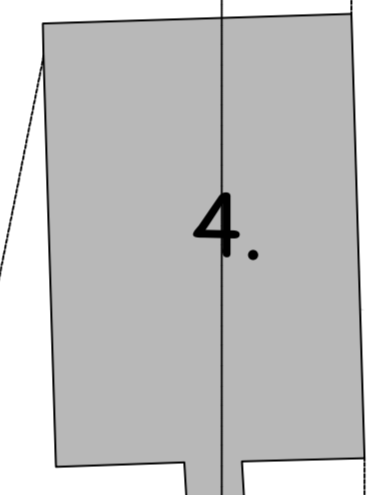
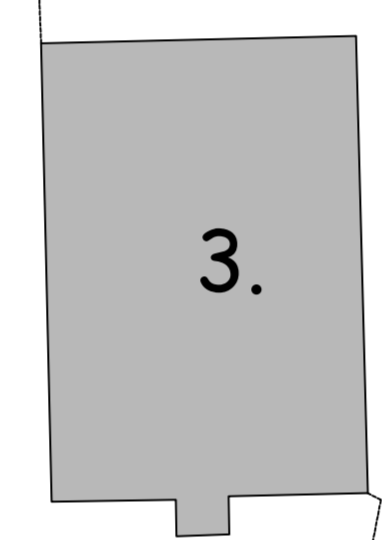
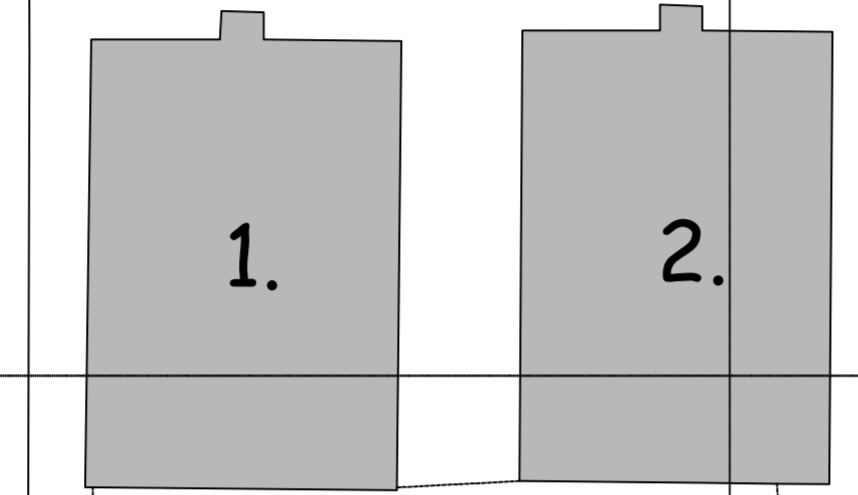

Tanks

302.4m

Sinks

Issues

ISS

309.2m

Byrn Golau